



# higher education & training

Department:  
Higher Education and Training  
**REPUBLIC OF SOUTH AFRICA**

## **NATIONAL CERTIFICATE BUILDING AND STRUCTURAL SURVEYING N5**

(8060045)

**28 June 2022 (X-paper)  
09:00–12:00**

**Drawing instruments and nonprogrammable calculators may be used.**

**This question paper consists of 5 pages, 1 addendum and 1 formula sheet.**

012Q1A2228

**DEPARTMENT OF HIGHER EDUCATION AND TRAINING**  
**REPUBLIC OF SOUTH AFRICA**  
NATIONAL CERTIFICATE  
BUILDING AND STRUCTURAL SURVEYING N5  
TIME: 3 HOURS  
MARKS: 100

---

**INSTRUCTIONS AND INFORMATION**

1. Answer all the questions.
  2. Read all the questions carefully.
  3. Number the answers according to the numbering system used in this question paper.
  4. Start each section on a new page.
  5. Only use a black or blue pen.
  6. Write neatly and legibly.
-

**SECTION A**

**QUESTION 1**

The following aerial photograph shows a portion of a residential suburb in a municipal area. Indicate whether the following statements are TRUE or FALSE by writing only 'True' or 'False' next to the question number (1.1–1.5) in the ANSWER BOOK.

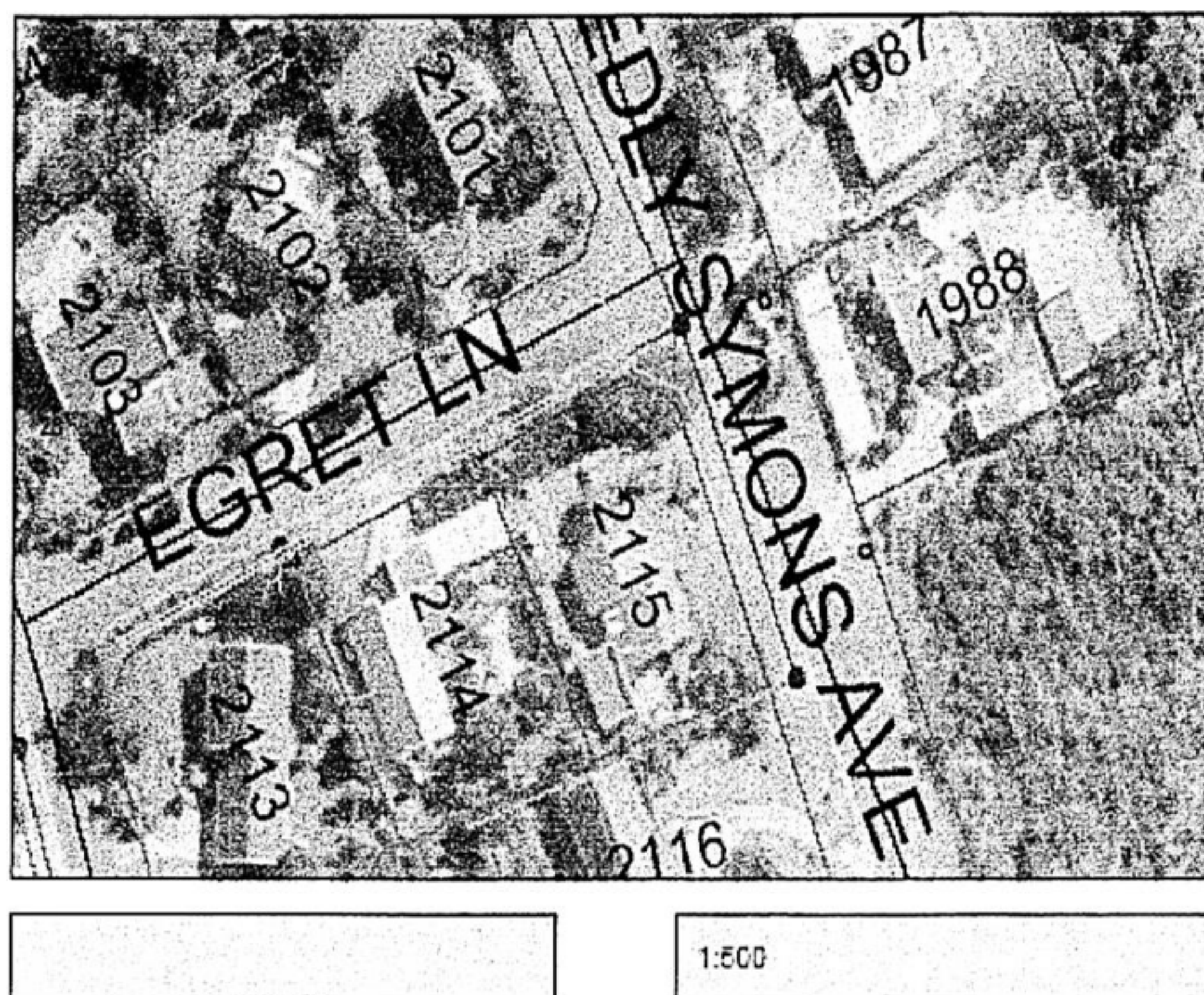
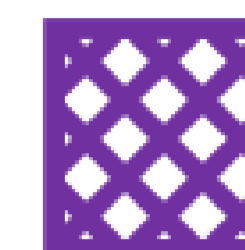

- 1.1 The scale of the photograph is 1:1 500.
- 1.2 One of the street names in the diagram is EGRET LN.
- 1.3 The erven in the photo are arranged in a particular sequence.
- 1.4 There are at least three clearly marked motorways in the diagram.
- 1.5 Township and suburb refer to the same type of residential area.



(5 × 2) [10]

**QUESTION 2**

Complete the following sentences by writing only the missing word or words next to the question number (2.1–2.5) in the ANSWER BOOK.

- 2.1 A traveller is usually made out of ...
- 2.2 Step chaining is a method used to determine a horizontal distance of a ...
- 2.3 Mistakes are mainly the results of miscounting, wrong observation and ...
- 2.4 Booking is mainly the entering of all survey information and measurements in the tache book and ...
- 2.5 Systematic errors recur in the same instrument and are ...



(5 × 2) [10]